

General description

Soft protective profile rubber. Depth provided with an adhesive strip for a better grip on duct profile. Designed for metal sheet of 0.6 to 1.5mm thickness. Fast assembly and allows to reach «C» class airtightness. Available pre-cut for each size of access doors or in roll of 100m.

- Designed for sheet metal 0.6 to 1.5 mm thick
- Quick and easy assembly without tools
- Allows access doors to reach the airtightness class «C»



Technical specification

Material	EPDM
Shore	20 / 25 Sh A
Color	Black
Adhesive	Rubber
Temperature of use	- 30°C / +100°C

Alogen and silicone free

Application

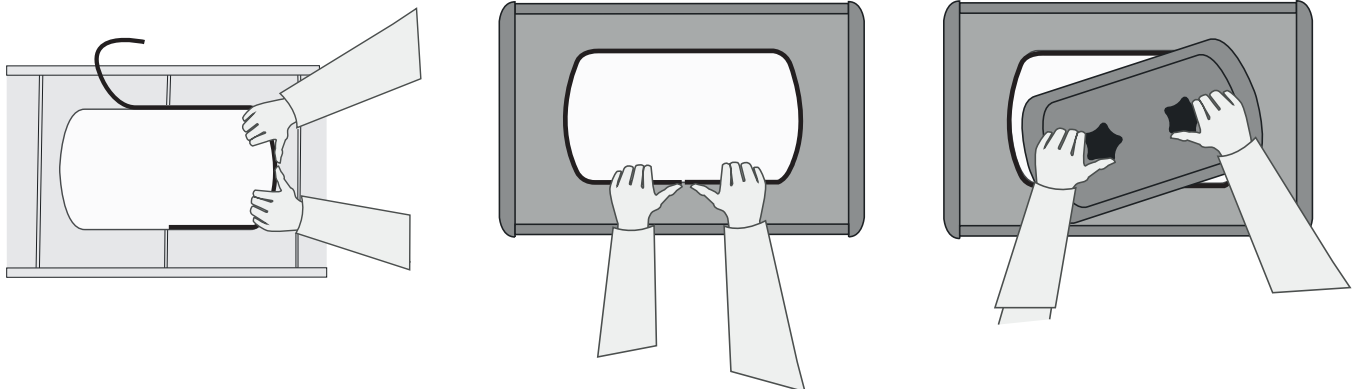



DE 633X206
VE 305/3/FR
Page 5/5

DE 633X206
VE 305/3/FR
Page 4/5

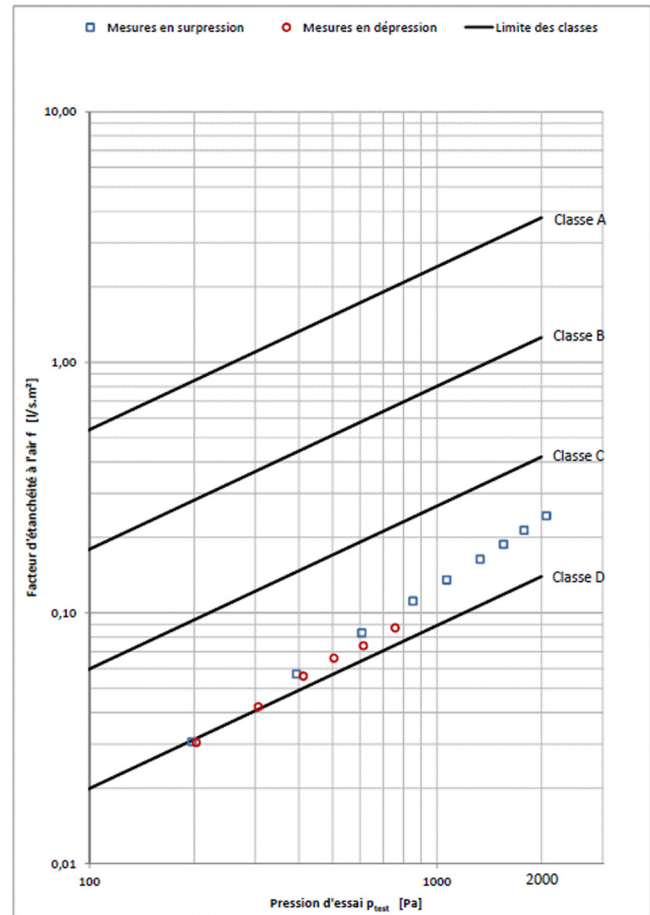

Information contained herein is based on careful tests and experience. It reflects our knowledge and is for guidance purpose only. It is given in good faith and user should ensure that the product is fit for purpose before any application. The quoted values are average and should not be taken as maximum or minimum values for specific purposes. Manufacturer and distributor are not responsible for any non-recommended use or consequential damage.